

- ▶ High protection slip rings
- ▶ Quick delivery
- ▶ Low cost
- ▶ Plenty of configurations available
- ▶ Signal and power circuits
- ▶ Compact size
- ▶ Low friction torque
- ▶ High reliability and duration
- ▶ Smooth operation
- ▶ In compliance with CE and ROHS

servotecnica



SRH 2578 *Series*



Model	Out. length "L" (typic - mm)		Nbr. of circuits		Circuits total nbr.
	IP 51	IP 65	Power (10-15A)	Signals (2A)	
SRH 2578-6P	55	70	6	-	6
SRH 2578-12S	55	70	-	12	12
SRH 2578-12P	79	94	12	-	12
SRH 2578-6P/12S	79	94	6	12	18
SRH 2578-24S	79	94	-	24	24
SRH 2578-18P	103	118	18	-	18
SRH 2578-12P/12S	103	118	12	12	24
SRH 2578-6P/24S	103	118	6	24	30
SRH 2578-36S	103	118	-	36	36
SRH 2578-24P	127	142	24	-	24
SRH 2578-18P/12S	127	142	18	12	30
SRH 2578-12P/24S	127	142	12	24	36
SRH 2578-6P/36S	127	142	6	36	42
SRH 2578-48S	127	142	-	48	48

ORDER CODE

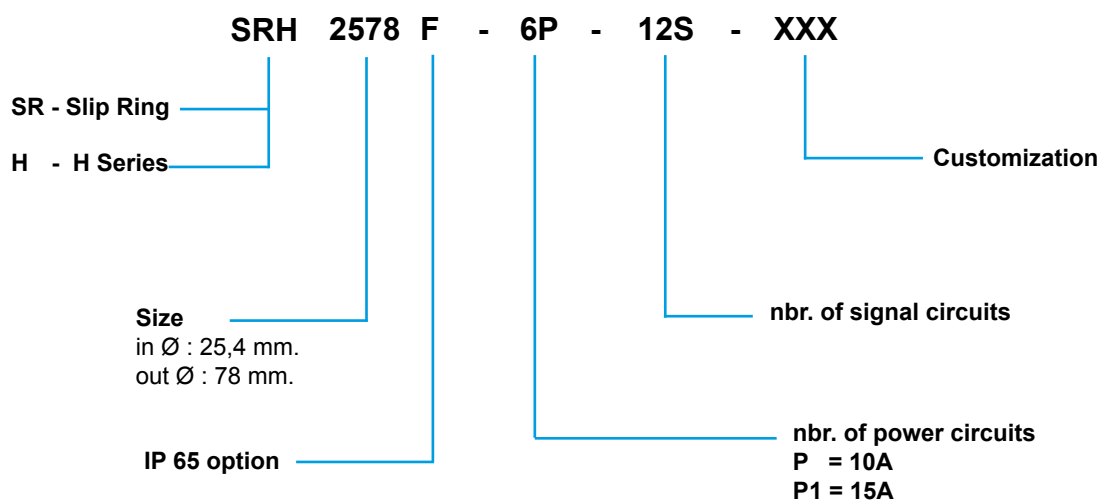

SRH 2578 Standard	Dimensions (mm)
-------------------	-----------------

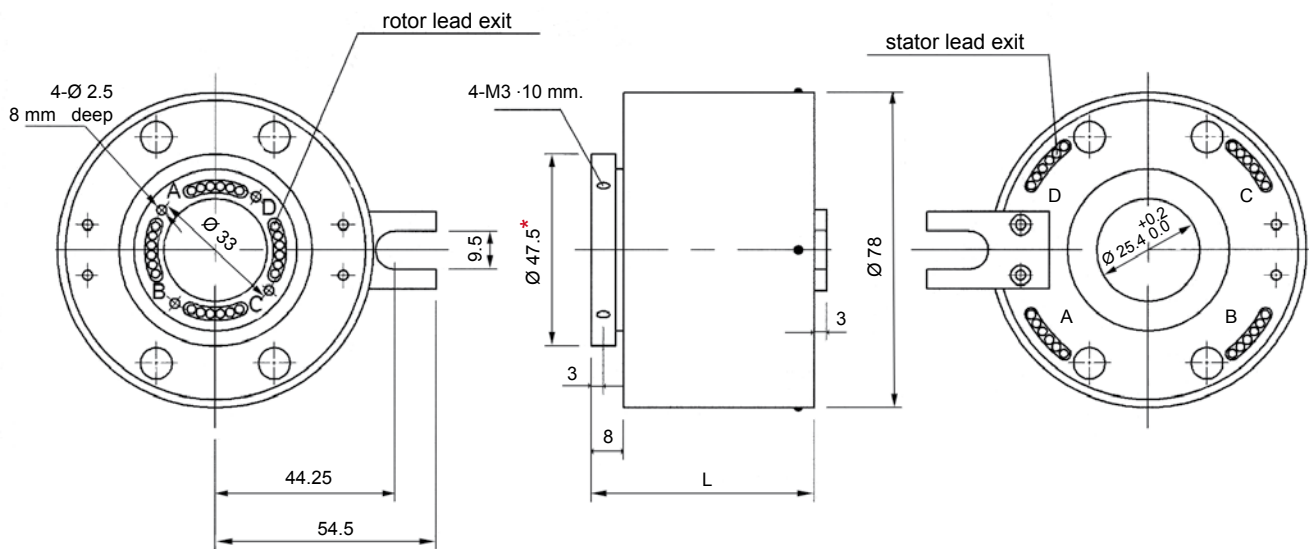

* 39,5 mm for IP 65 version

"L" Length tolerance ± 1 mm.

OTHER MODELS AVAILABLE

SRH Series



SRC Series



SRT Series



SRH 2578 Series

Slip rings can be used in any electromechanical system requiring unrestrained, continuous rotation while transmitting power and/or data from a stationary to a rotating structure.

A slip ring is also called rotary electrical interface, collector, swivel or rotary joint.

Thanks to the use of noble metals and to a new technology (allowing multiple contact points between brushes and ring) electric noise and interferences among circuits are considerably reduced, besides granting low contact electric resistance.

This model can also be delivered combined with pneumatic, hydraulic and fiber optic rotary joints.

No lubrication required.

Standard applications

- ▶ Rotary tables and machine tools
- ▶ Cable reels - winches
- ▶ Packaging machines
- ▶ Labelling machines
- ▶ Filling machines
- ▶ Converting machines
- ▶ Pallets
- ▶ Robots
- ▶ Medical equipment

Standard features

- ▶ Nbr. of circuits: 6, 12, 18, 24, 36, 48
- ▶ Current: power 10A: AWG16 / 15A: AWG14 - signals 2A: AWG26 *
- ▶ Voltage: power 600 VAC / VDC - signals: 240 VAC / VDC
- ▶ Cables: silver plated; insulation PTFE / 4 cables output: 6 x AWG16 or 12 x AWG26 ea.
- ▶ Cables length: standard 300 mm. (other lengths on demand)
- ▶ Dielectric strength: power: 1500 VAC at 60 Hz, 60 sec. - signals: 500 VAC at 60 Hz, 60 sec.
- ▶ Insulation resistance: power: > 1000 MΩ / 500 VDC - signals: > 500 MΩ / 500 VDC
- ▶ Dynamic contact resistance: < 0.01 Ω
- ▶ Nominal speed: 0 to 600 rpm. (for higher speeds please contacts us)
- ▶ Bearings: steel
- ▶ Housing: ABS (hard plastic)
- ▶ Temperature: -40°C to +80°C
- ▶ Protection: IP 51 (option IP 65)

* Length remains unchanged by varying of the power circuits current (10A, 15A)